

PART NAME

PLASTICASE

PART No.

PC-11491

MATERIAL: BODY TOP & BOTTOM, REAR PANEL _____ ABS THERMOPLASTIC (UL94-HB RATED)
 SLOPE PANEL _____ 0.080 THK. ALUMINUM

FINISH: BODY TOP & BOTTOM _____ LIGHT GRAY
 REAR PANEL _____ DARK GRAY
 SLOPE PANEL _____ NATURAL

REMOVABLE ALUMINUM PANEL (PRESSURE SENSITIVE TAPE ON ONE SIDE)

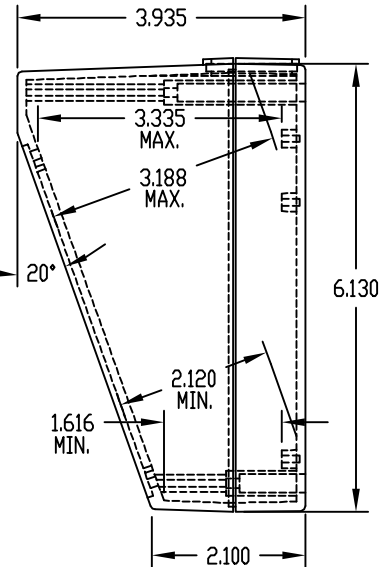
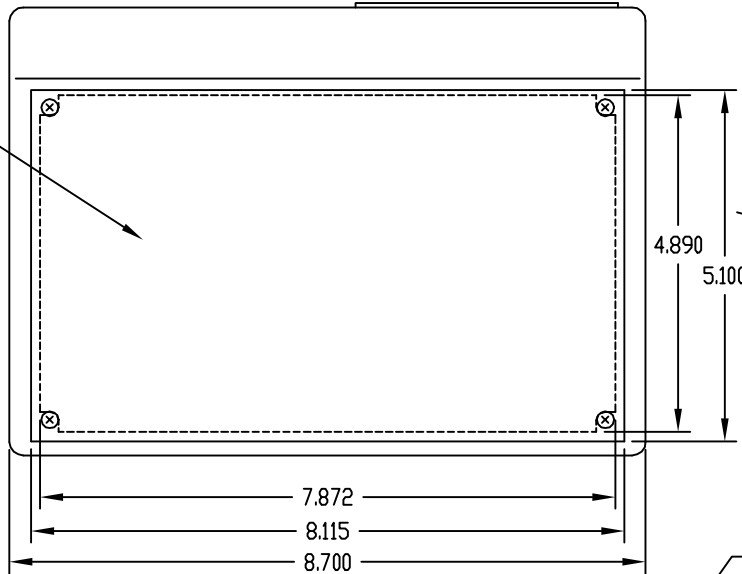

0.250 DIA. BOSS WITH 0.094 DIA. HOLE (8) PLACES

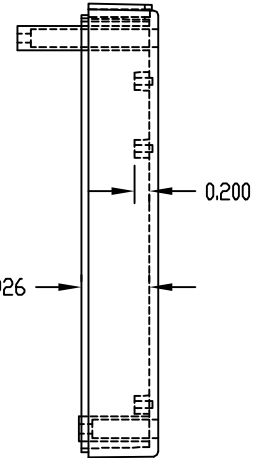
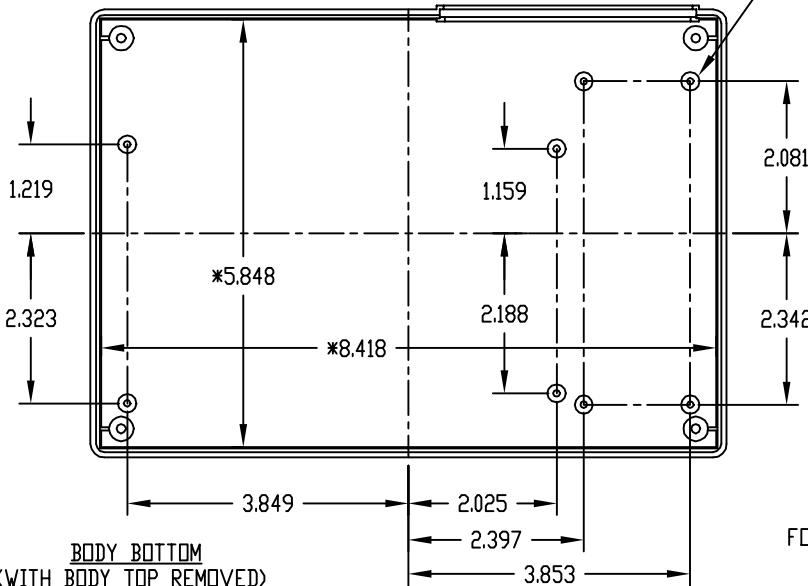

BODY BOTTOM (WITH BODY TOP REMOVED)

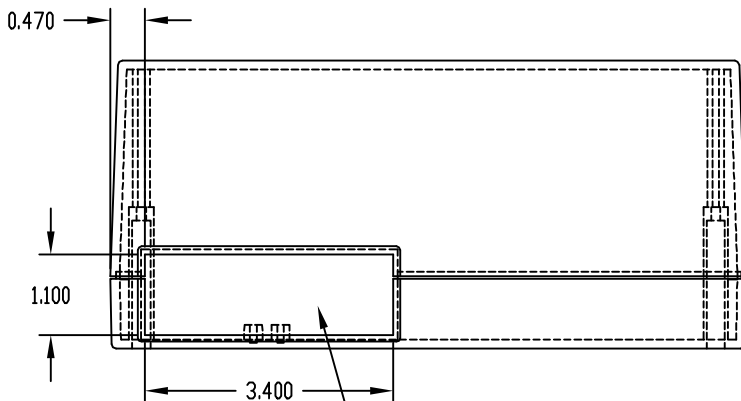

REAR VIEW

REMOVABLE REAR PANEL 0.090 THICK (TEXTURED ON ONE SIDE)

FOUR (4) M3 x 0.630" LG. SCREWS SUPPLIED FOR ASSEMBLING BODY TOP TO BOTTOM

FOUR (4) M3 x 0.315" LG. CSK. SCREWS SUPPLIED FOR ASSEMBLING SLOPE PANEL TO BODY TOP

FOUR (4) RUBBER PUSH-ON FEET SUPPLIED

MOUNTING BOSSES USE EITHER M2.5 METRIC OR #4 STD. SHEET METAL SCREWS x 0.188" LG. (NOT SUPPLIED)

NOTE: ALL DIMENSIONS HAVE ±0.015 TOLERANCE UNLESS OTHERWISE SPECIFIED

* THESE INSIDE DIMENSIONS ARE TAKEN FROM CLOSED END OF THE BOX. DIMENSIONS INCREASE SLIGHTLY AT OPEN END DUE TO TAPER.